

# WELCOME

**We're thrilled that you're here to worship with us today!**

## ARE YOU NEW HERE?

Please text "Welcome" to 209-841-5173 and share a bit about yourself, or fill a Connection Card (found in pew-back in front of you), and put it in the offering plate. And be sure to get your welcome packet (found in the lobby) before you leave!

## WHAT TO EXPECT...

Our worship service is designed around music, a relevant Bible-based message about God and life, and a response to that message. We are usually finished by 12:15p.

## TODAY'S EVENTS

- 9:30a** Bible Study Groups for all ages
- 10:30a** Connections, Hospitality Area
- 10:45a** Bible Adventurers, BLC
- 11:00a** Worship, Sanctuary
- 6:05p** Sundown time, Sabbath ends

## THIS WEEK'S EVENTS

### Sunday

- 2a** Daylight Savings Time Begins

### Tuesday

- 10a** Quilting Group, BLC
- 11a** Ladies' Lunch, Olive Garden

### Wednesday

- 7p** Prayer Meeting, Room 5
- 6p** Scrapbooking, BLC
- 7p** Discipleship Group, Lanza Home

### Thursday

- 10a** Staff Meeting, Pastor's Office

### Friday

- 8a-9a** Community Breakfast, BLC
- 12:15p** Ladies Bible Study, Lanza Home
- 7:11p** Sundown time, Sabbath begins

## OFFICE INFORMATION

**SECRETARY HOURS**  
**9a-12p, MON-FRI.**

**PHONE NUMBER**  
**209-835-5342**

**E-MAIL ADDRESS**  
**OFFICENCTRACYSDA**  
**@GMAIL.COM**

**MAILING ADDRESS**  
**2025 HOLLY DR., 95376**

## Online Giving

AS AN ALTERNATIVE TO PLACING YOUR GIFT IN THE OFFERING PLATE, YOU MAY GIVE TO OUR CHURCH WITH A CREDIT CARD 1) THROUGH OUR WEBSITE, (BIT.LY/2FINO0V) OR 2) THROUGH THE "ADVENTIST GIVING" APP AVAILABLE ON ALL MOBILE DEVICES.

# ANNOUNCEMENTS

**CURRENT SERMON SERIES** Pastor Tyler is presenting a six-part sermon series about the glory that is found in the process of growth and transformation which focuses on our church's commitment to growing young. We've learned about Keychain Leadership (empowering young people and sharing the keys with them), empathizing with today's young people (don't judge or criticize, but step into their shoes), what it means to Jesus' message seriously, and the need to provide a warm community. Today we're looking at the importance of prioritizing young people (& families) everywhere.

**CHURCH WORK BEE** It's almost that time of year for spring cleaning! Just as we need to work to keep our own houses in good shape, we need to do our best to keep God's house looking good. So, please plan to join us on Sunday, March 8, starting at 2p for an afternoon of church beautification.

**CHURCH RECORDS** We're wanting to make sure we have up-to-date information for our records of our church family - including all members and attenders. Would you please text the word "Update" to 209-841-5173 (do not call) and answer the 4 questions? The information is only available for use by the church office. Thank you!

**LADIES' LUNCHEON** All ladies are invited to come to the Olive Garden on Tuesday, March 10 at 11a. This is a monthly event, so plan on joining us every second Tuesday of the month. You will definitely want to be part of the fellowship and fun!

**ANNUAL CHURCH CAMPOUT** Mark your calendars for April 17-19 as that will be our yearly church campout at Lake McSwain. There are only a few sites left, so reserve your campsite now at with Nona in church office.

**GRADUATION POTLUCK** Every year our church family loves to celebrate our graduates. It doesn't matter if you're graduating from elementary school, high school, college, or post-graduate school, we want to celebrate your achievement! So, if you are graduating this spring, please let Joyce Western know as she is making plans for a special Sabbath potluck lunch.

## CELEBRATE WITH...

*Anniversary (A); Birthday (B)*

- |                                  |                             |
|----------------------------------|-----------------------------|
| <b>3/7</b> Crystal Kraft (B)     | <b>3/15</b> Pat Kibbe (B)   |
| <b>3/10</b> Becky Lanza (B)      | <b>3/16</b> Kelly Graff (B) |
| <b>3/10</b> Robert Miller (B)    | <b>3/16</b> Jim Beierle (B) |
| <b>3/11</b> Bob & Sue Miller (A) |                             |

## FRIENDLY FACES

**Tyler Kraft**  
*Pastor*

562-665-8676  
tylerkraft@nccsda.com



**Becky Lanza**  
*Head Elder*

209-835-6065  
beckylanza@yahoo.com



**Bess Haldi**  
*Treasurer*

209-814-4947  
bhaldi@msn.com



**Nona Cody**  
*Church Secretary*

209-835-5342  
officencrtracysda@gmail.com



**Jim Beierle**

*Tracy SDA Elementary Principal*  
209-835-6607  
tracysdae elementary.org



## BOARD OF ELDERS



Rod Western



Kimberly Riddle



Leo Porras



Michael Ahn



*Elder in Training*  
Sony Zachariah

**Elder On-Call:** Leo Porras 209-483-9499

## CONNECT WITH US ONLINE



tracysdachurch.org

facebook.com/TracySDAChurch



YouTube bit.ly/2megGF2

SCRIPTURE EMPHASIS

Then Jesus called for the children and said to the disciples, “Let the children come to me. Don’t stop them! For the Kingdom of God belongs to those who are like these children.

Luke 18:16

MY NOTES

CHURCH MAP

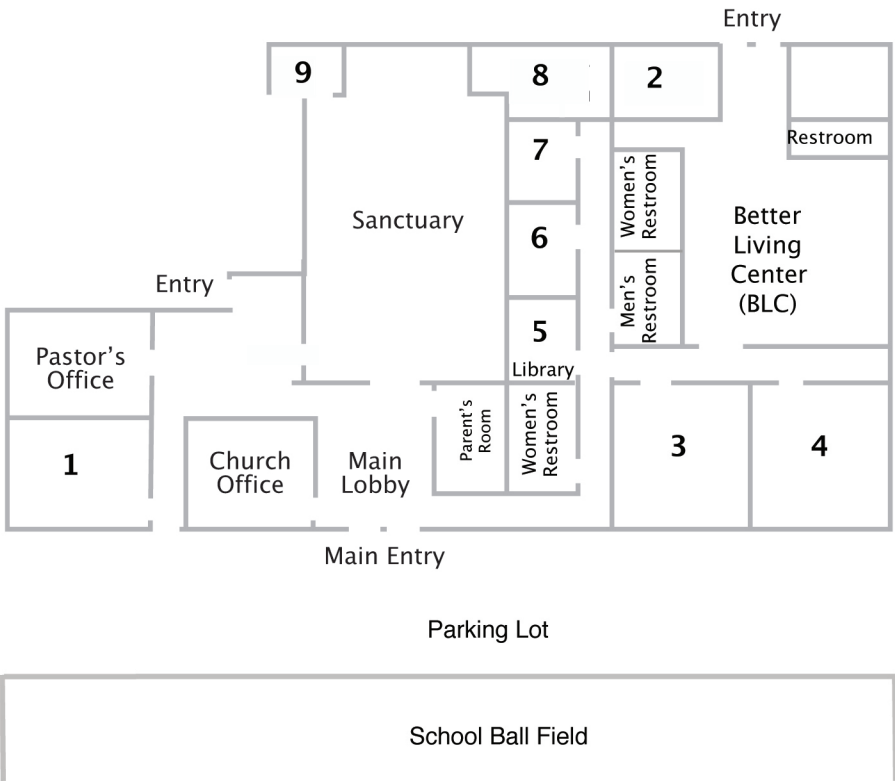

TRACY ADVENTIST CHURCH

LOVING, SERVING, AND GROWING THE KINGDOM, ONE PERSON AT A TIME



Glory and Growth

Prioritize



March 7, 2020

9:30a Bible Study Groups

(see map on back)

Young People

Beginners (Ages 0-K) | Room 4

Kingdom Kids (Grades 1-6) | Room 7

Teens (Grades 7-12) | Room 1

Adults

Daniel | Room 2

Discussion of lesson quarterly

Care Class | Room 3

In-depth Bible study

Desire of Ages | Room 8

Study of inspirational book

11:00a Worship

Call to Worship

Songs of Praise

Praying Together | Becky Lanza

Song of Worship

Message | Pastor Tyler Kraft

Glory and Growth, Pt. 5

Song of Response

Tithes and Offerings

Tracy Church Ministries

Time of Response

Blessing and Postlude

OUR MINISTRIES AND LEADERS

Children - Kimberly Riddle

Music - Diana Cefalo

Discipleship Groups - Tyler Kraft

Prayer Meeting - Wes Huffman

Teens - Kimberly Riddle

Quilting - Kathy Igarashi

Community Feeding - Sue Miller & Irene Laban

Deacons - Dick Lanza & Joyce Western

Health - Crystal Kraft

Retirement Home - John & Alyson Cloke

Tracy Adventist Elementary - Jim Beierle

Women - Bess Haldi

TODAY'S VOLUNTEERS

Deacons: Joyce W., Carly M., Mitch P.

Greeter: Tony K.

Audio/Visual: Bob M., Doug H.

Bible Adventures: Wes H.

All songs used by permission: CCLI License #25376

TALK

How has your life been impacted by you taking Jesus' message seriously?

WALK

Talk with a non-Christian (or non-churchgoer) and ask "What Bible text or Christian belief do you find most troubling?" Just listen without becoming defensive, and say "Thank you for sharing."